

12.1" LCD Monitor

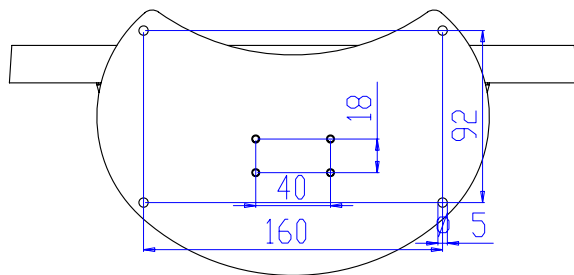

Specifications

Model Name	JGM121F01S02
LCD Specifications	
Display Type	12.1"active matrix TFT LCD panel
Resolution	800 x 600
Brightness	200 cd/m2
Contrast Ratio	150:1
Display Colors	16.2M
Pixel pitch(mm)	0.3075(H)*0.3075(V) mm
Display Area(HxW)	184.5(H)*246.0(W) mm
Viewing Angle(H-V)	L/R : 70/70 , U/D : 40/70
Backlight MTBF	15000 hrs
H Frequency input Range	30KHZ—80KHZ
V Frequency input Range	56HZ---75HZ
Other Features	
Signal Input	Analog: 15-pin-D-SUB
Touch Screen	
Port	
Keypad	Power, Auto Adjust, Menu, up, down
OSD Function	Brightness, Contrast, Display Adjust OSD Adjust, Language, Color Temperature, Audio Control, Input Select Reset, Exit
Environment	
Humidity:	Operation: 20%~80%, Storage: 20%~80%
Temperature:	Operation: 0℃~40℃, Storage: -20℃~60℃
Physical	
Construction Front Panel	ABS+PC plastic front frame
Construction Chasis	
Mounting	VESA 75 x 75mm
Color	Black
Dimension (HxWxD)	246.3(H)*303.7(W)*142(D) mm
Weight (N/G)	
Power	
Power Supply	36 W power adapter Input: 100~240V, 50~60Hz Output: 12 VDC, 3.0A
Power Requirement	12 VDC
Power Consumption	30W

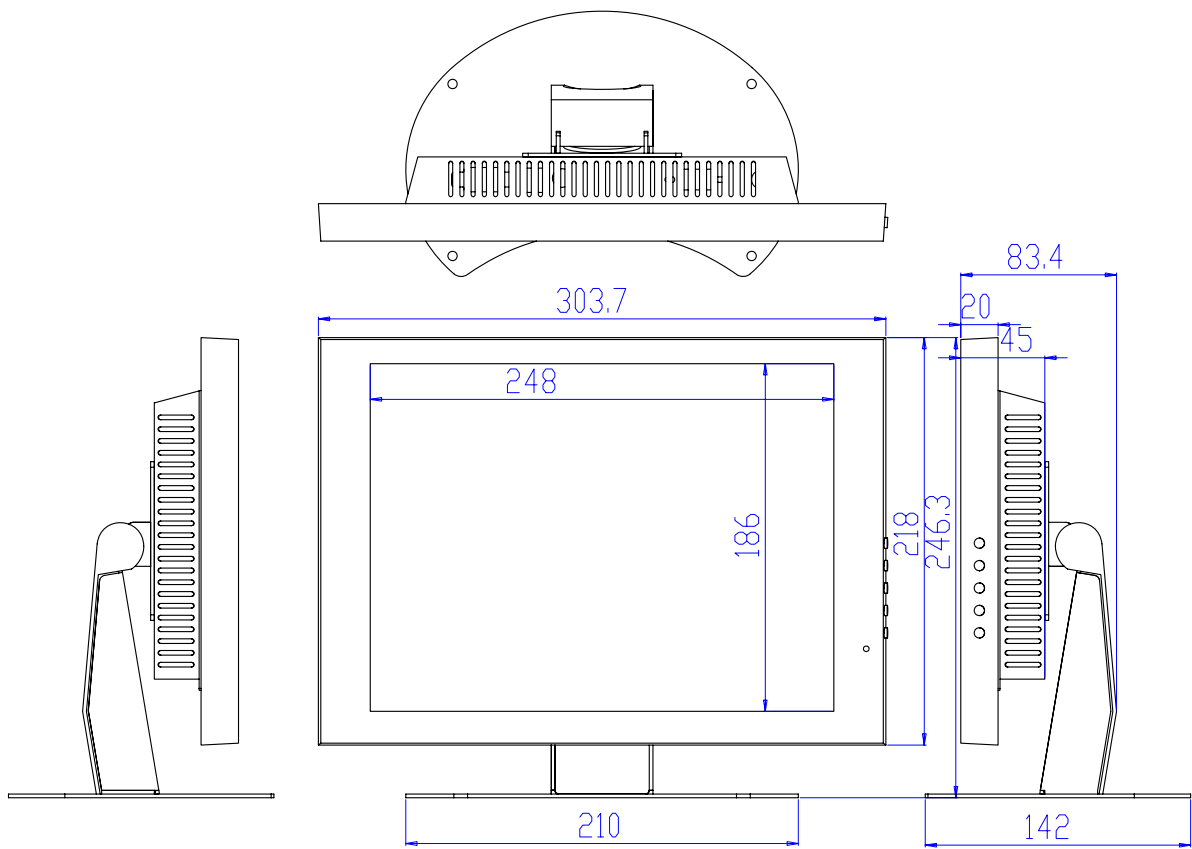

壁掛孔 75x75mm

